

# \$349,000 - #17 54102 Range Road 274, Rural Parkland County

MLS® #E4451541

**\$349,000**

0 Bedroom, 0.00 Bathroom,  
Rural on 2.00 Acres

Brenmar Estates, Rural Parkland County, AB

Beautiful acreage living on 2 acre + lots at Brenmar Estates Phase 2! Convenient location - 5 MIN to Spruce Grove. ONLY 20 MIN to Edmonton - surrounded by natural trees and forest for added privacy. Built on a brand new paved Campsite Road, several lots are pre approved for a shop and secondary garage potential. Power and gas are at the property line. Choose the builder you prefer! Enjoy a perfect combination of country living in a architecturally controlled subdivision with quick access to Spruce Grove, St. Albert and Edmonton.

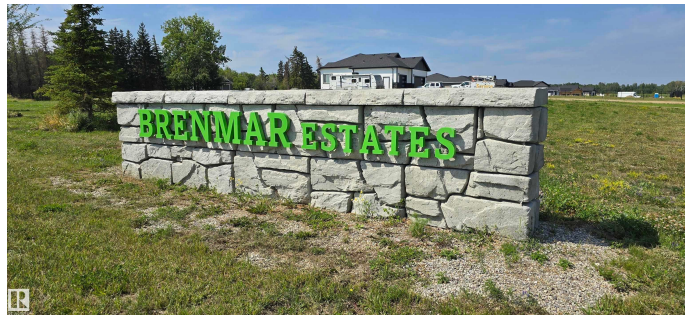

## Essential Information

MLS® #	E4451541
Price	\$349,000
Bathrooms	0.00
Acres	2.00
Type	Rural
Sub-Type	Vacant Lot/Land
Status	Active

## Community Information

Address	#17 54102 Range Road 274
Area	Rural Parkland County
Subdivision	Brenmar Estates

City	Rural Parkland County
County	ALBERTA
Province	AB
Postal Code	T7X 3S4

### **Exterior**

Exterior Features Private Setting, Rolling Land, See Remarks

### **Additional Information**

Date Listed August 3rd, 2025

Days on Market 20

Zoning Zone 70

DATA IS DEEMED RELIABLE BUT IS NOT GUARANTEED ACCURATE BY THE REALTORS® ASSOCIATION OF EDMONTON. COPYRIGHT 2025 BY THE REALTORS® ASSOCIATION OF EDMONTON. ALL RIGHTS RESERVED. Trademarks are owned or controlled by the Canadian Real Estate Association (CREA) and identify real estate professionals who are members of CREA (REALTOR®, REALTORS®) and/or the quality of services they provide (MLS®, Multiple Listing Service®)

Listing information last updated on August 23rd, 2025 at 7:02pm MDT