

\$79,900 - 4603 Lily Court, Cold Lake

MLS® #E4410372

\$79,900

0 Bedroom, 0.00 Bathroom,
Single Family on 0.00 Acres

Brady Heights, Cold Lake, AB

Attention Builders: Discover the Potential of Urban Living with this exceptional lot nestled in Cold Lake South's newest development area. Encompassing 517 square meters of opportunity, this vacant parcel presents an ideal canvas for crafting a remarkable spec home that seamlessly integrates into the city's landscape.

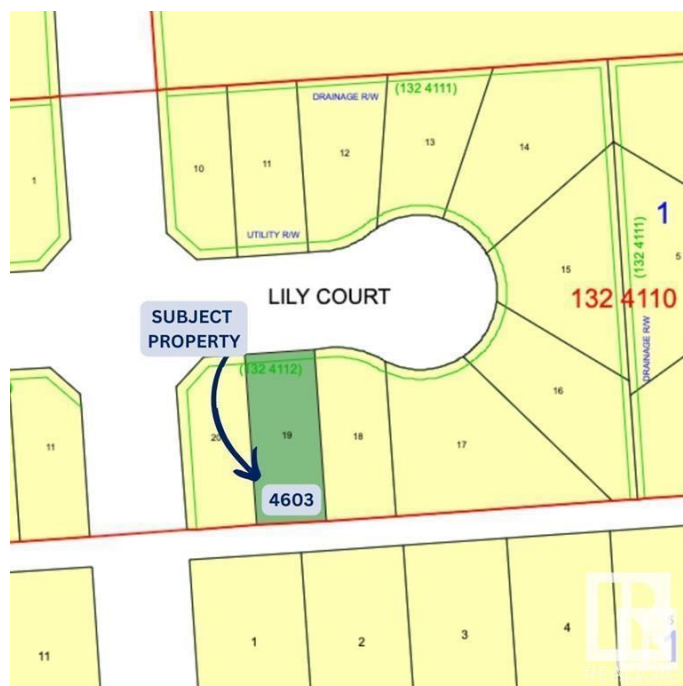

Essential Information

MLS® #	E4410372
Price	\$79,900
Bathrooms	0.00
Acres	0.00
Type	Single Family
Sub-Type	Vacant Lot/Land
Status	Active

Community Information

Address	4603 Lily Court
Area	Cold Lake
Subdivision	Brady Heights
City	Cold Lake
County	ALBERTA
Province	AB
Postal Code	T9M 0J4

Exterior

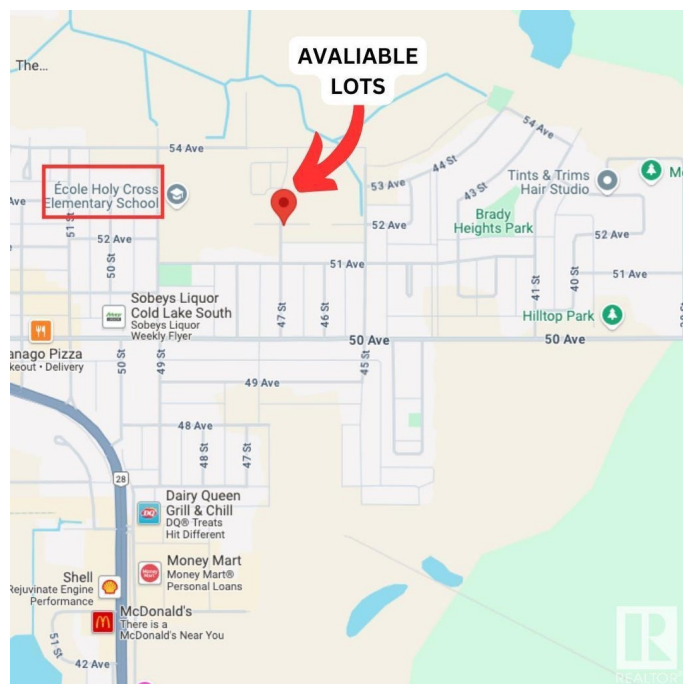

Exterior Features Flat Site, Playground Nearby, Public Transportation, Schools

Additional Information

Date Listed October 15th, 2024

Days on Market 264

Zoning Zone 60

DATA IS DEEMED RELIABLE BUT IS NOT GUARANTEED ACCURATE BY THE REALTORS® ASSOCIATION OF EDMONTON. COPYRIGHT 2025 BY THE REALTORS® ASSOCIATION OF EDMONTON. ALL RIGHTS RESERVED.Trademarks are owned or controlled by the Canadian Real Estate Association (CREA) and identify real estate professionals who are members of CREA (REALTOR®, REALTORS®) and/or the quality of services they provide (MLS®, Multiple Listing Service®)

Listing information last updated on July 6th, 2025 at 7:17am MDT